



HXE130

Single Phase
Smart Keypad
Prepayment Meter

Focus on creating value for clients

HXE130

HXE130 is a new generation of single phase smart keypad prepayment/postpayment meter which migrating STS/CTS with AMI functions. It provides local and remote credit charging. The meter is supported by Hexing's AMI and vending system software. The meter can be designed by integrated type or split type.



Main functionalities

Measurement

- 1P2W connection
- Import & Export & Total & Net kWh
- Import & Export kvarh (optional)
- Four-quadrant kvarh(optional)
- Total & Per tariff

Instantaneous Values

- Power, voltage, Current
- Power Factor, Frequency

Power Quality Monitoring

- Under & Over voltage
- Power down

RTC (Real Time Clock)

- Quartz crystal time resource
- Gregorian calendar
- DST (Daylight Saving Time, optional)
- Lithium battery (exchangeable/inner, 10 years support)

Billing Data

- At least 12 monthly billing periods
- At least 62 daily billing periods
- Automatic reset/ Manual reset

Local and Remote Access

- PC software

Events & Alarms

- Load and power grid events detection
- Customizable event list
- At least 200 event records
- Internal self-check
- Alarms indicator (LED/LCD)
- Event date and time
- Buzzer alarm

LCD

- Display area size 66mm×23mm
- Display digital size 10mm×6mm
- Backlight (optional)
- Configurable automatic & manual display list
- Test mode
- OBIS codes (according to IEC62056-64)

Keypad

- Optional keypad integrated into meter or split type.

Load Control

- 80A/100A(Max) relay integrated , UC2
- Load control according to power threshold (programmable)
- Local &remote load control
- Relay status indicator

Communication

- HHU
- MDC & Vending system
- CIU(optional)

Load Profile (optional)

- Up to 16 Megabytes of non-volatile memory
- Over 100 days storage (8 channel, 15 minutes)
- Up to 8 channels
- 8 captured objects per channel
- Capture period (15, 30, 60, ...1440 min)
- Energy, power, voltage, current, frequency, etc.
- Maximum/minimum/average value

Tariffs (optional)

- Up to 4 tariffs
- Up to 8 day tables
- Up to 12 week tables
- Up to 12 season tables
- Up to 100 holiday & special days tables

Prepaid

- STS/CTS standard(optional)
- Emergency Credit
- Friendly Mode(optional)
- Local & Remote charge
- Prepaid & Post-paid

- Optical port: DLMS IEC62056-21E/ HDLC
- HAN port:RS485(RJ12)/M-bus/MC171(optional)
- Modular plug-play 2G/3G/PLC/RF communication

Anti-Tamper

- Mechanical seals (terminal, body, module)
- Physical detection(terminal, body, module)
- Current reverse
- Strong magnetic field detection(optional)
- Bypass detection(optional)
- Optical port sealable(optional)

Security

- Different data access levels
- Data access management for all ports
- Metrology data protection

Demand Monitoring (optional)

- Block/Slide mode
- Programmable integration period (typically 5, 10, 15, 30 or 60 minutes)
- Import & Export kW, kVarh, KVA(optional)
- Historical consumption value
- Pre-set time (automatic) /Manual reset (button/communication)

Specifications

APPLICATION		Direct connection
ACCURACY	Active	Class 1 (IEC)
	Reactive(optional)	Class 2 (IEC)
NOMINAL VOLTAGE	1 phase 2 wire	120V...240V (-20%...20%)
CURRENT RANGE	Ib/ Iref	5A, 10A
	I _{max}	80A, 100 A
STARTING CURRENT	According to IEC	0.4%I _b
FREQUENCY		50 / 60Hz, +/-5%
POWER CONSUMPTION	Phase voltage	230V
	Voltage circuit	< 2W, < 10VA
	Current circuit	<0.1VA
TEMPERATURE RANGE	Operation	- 25 ° C to +55° C
	Storage	- 40 ° C to +70 ° C
HUMIDITY RANGE		Up to 95%
PROTECTION DEGREE		IP 54(Indoor)
EMC	Electrostatic discharge	Contact discharge 8KV
		Air discharge 15KV
	Fast transient burst	4KV
	Surge immunity	6KV
	Electromagnetic RF Fields	Frequency range 80kHz to 2000MHz
		With current 10V / m
	Without current 30V / m	
	Conducted disturbance	Frequency range 150kHz to 80MHz

		Voltage level 10V
	Radio interference(peak value)	30MHz~1GHz < 30dB
INSULATING STRENGTH	Impulse voltage	6KV 1.2 / 50 μs
	AC voltage	4KV
RTC	Clock Accuracy	< 0.5s / day
STANDARDS	IEC standard	IEC62052-11 IEC62053-21
		IEC62053-23 IEC62055-41
		IEC62055-51 IEC62056-46
		IEC62056-47 IEC62056-53
		IEC62056-61 IEC62056-62
COMMUNICATION	Built-in	Optical /RS485/ MC171/M-Bus
	Modules (optional)	2G / 3G / PLC/ RF-Mesh
OUTPUT/INPUT	Energy impulse LED	1 for active energy
		1 for reactive energy
	Alarm / Status LED	1 for credit status indicator
		1 for alarm indicator
OUTPUT/INPUT	1 x Electronic output (optional)	acc. IEC 62053-31
DATA STORAGE	Load profile(optional)	8 Channels
	Billing data	12 Billing periods
INSTALLATION	Type	BS 7856
BATTERY		Exchangeable
DISCONNECTOR	Maximum switch voltage	250V
	Maximum switch current	80A/100A
	Short circuit <= 10ms	2400A/3000A (according to IEC62053-21)
HOUSING MATERIAL		Polycarbonate + GF

CONNECTION

Terminal Size

8.7 mm x 8.2 mm

WEIGHT

About.0.81 kg(without module)

About.0.87 kg(with module)

DIMENSION

(H x W x D)

(164mm-254mm)x 130mmx 67mm

■ Typical Dimensions

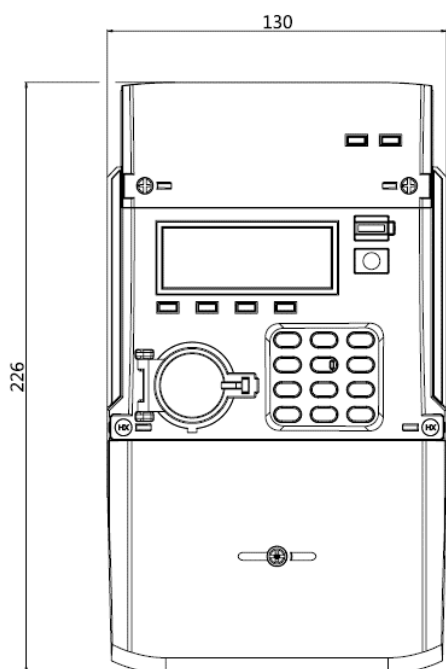

With modem

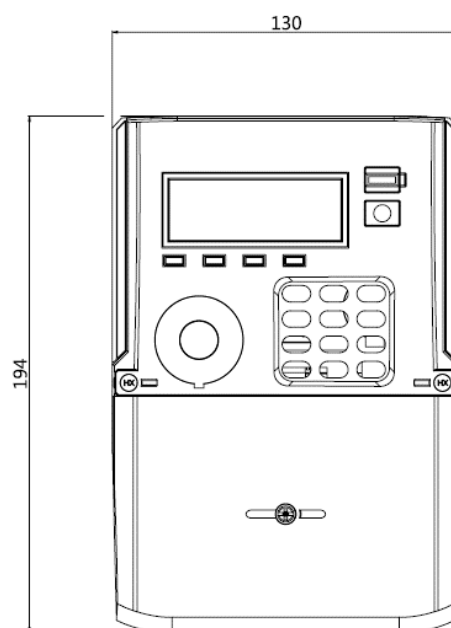
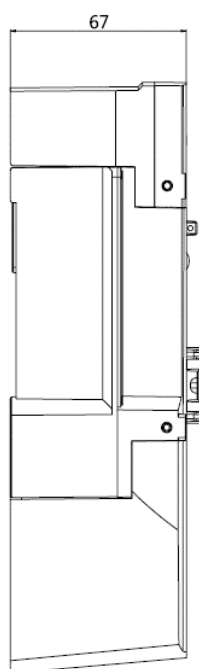

Without modem

■ Terminal drawing

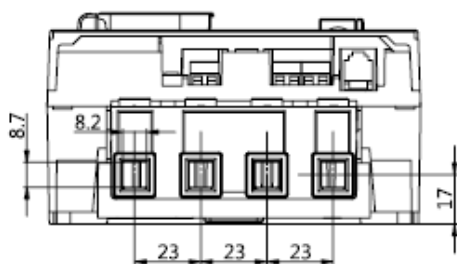

■ Connection Diagram

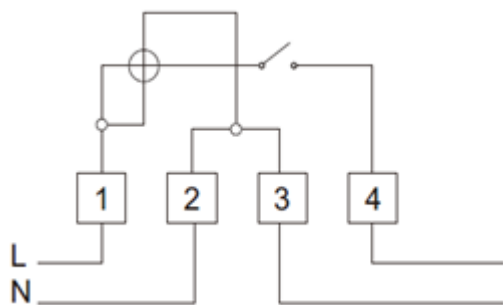

COMPANY HEADQUARTERS

Add: 1418-5 Moganshan Road,
Shangcheng Industrial Zone, 310011,
Hangzhou City, China

TeI: 86 571 28029898

Fax: 86 571 28029258

To realize a sustainable future, start here

www.hxgroup.cn